

PMD SERIES

INFOGRAFICHE / INFOGRAPHICS

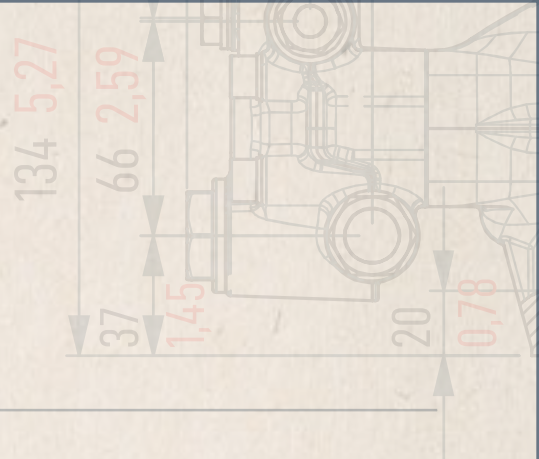

PORTATA / FLOW RATE

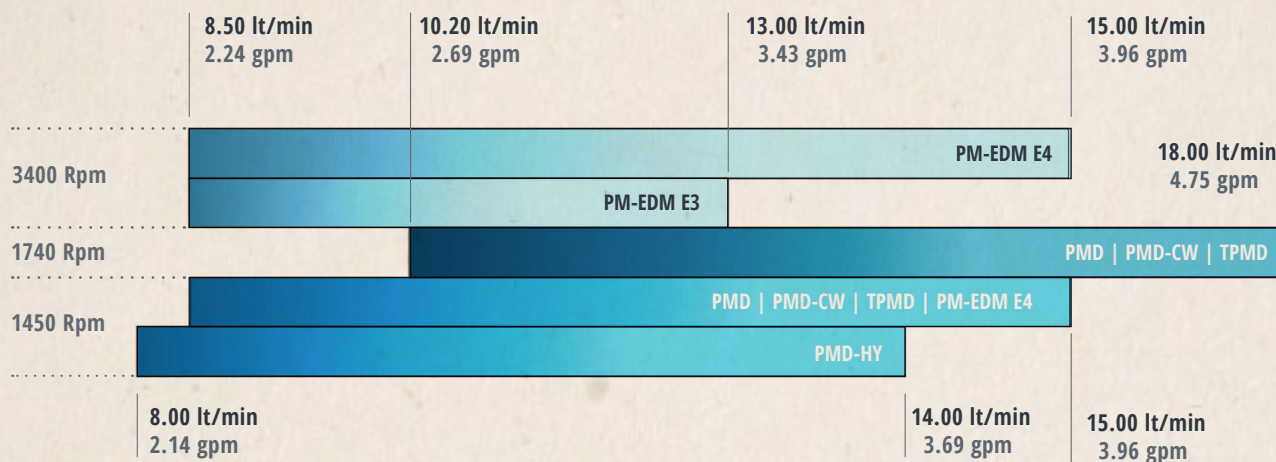

PRESSIONE MASSIMA MAX PRESSURE

TEMP. MASSIMA ACQUA MAX WATER TEMP.

200 Bar / 2900 Psi

PMD
PMD-CW
PMD-HY
PM-EDM E3
PM-EDM E4



150 Bar / 2175 Psi

TPMD

65° C / 149° F

PMD
PMD-CW
PMD-HY
PM-EDM E3
PM-EDM E4

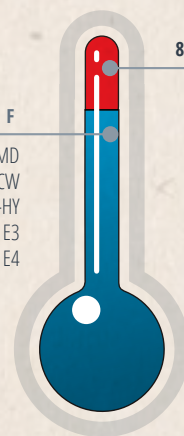

85° C / 185° F

TPMD

INDICE DI SEZIONE / SECTION INDEX



PMD

20



PMD-CW

22



TPMD

24



PMD-HY

26



PM-EDM E3

28



PM-EDM E4

28

COLD WATER

ELECTRIC

BRASS HEAD

PMD



MAX TEMP. ACQUA
MAX WATER TEMP.

C: **65.00°**
F: **149.00°**



PORTATA MAX
MAX FLOW RATE

L/min: **18.00**
Gpm: **4.75**



PRESSIONE MAX
MAX PRESSURE

Bar: **200.00**
Psi: **2900.00**

ATTACCHI / CONNECTIONS

INGRESSO / INLET	G 1/2"
USCITA / OUTLET	G 3/8"

Frequenza Frequency	Portata Flow rate		Giri Revolutions	Pressione minima Min Pressure		Pressione massima Max Pressure		Capacità olio Oli Capacity		Peso Weight	
	Hertz	L/min		Gpm	Bar	Psi	Bar	Psi	Lt	Gal	Kg
50Hz	8.50 - 15.00	2.24 - 3.96	1450	0.2	2.9	200	2900	0.4	0.1	7.5	16.53
60Hz	10.20 - 18.00	2.69 - 4.76	1740	0.2	2.9	200	2900	0.4	0.1	7.5	16.53

CARATTERISTICHE / FEATURES

- ✓ Testata in ottone
- ✓ Aste pistoni di guida rettificati per una riduzione dell'attrito durante lo scorrimento
- ✓ Albero sovradimensionato con terminale per una migliore trasmissione della coppia
- ✓ Pistoni in ceramica di grosso spessore per una maggiore durata
- ✓ Sistema di tenuta a doppia guarnizione
- ✓ Valvole di aspirazione e mandata con passaggi acqua maggiorati
- ✓ Cuscinetti a sfera ad alta resistenza
- ✓ Forma del corpo pompa studiato per resistere nel tempo
- ✓ Bielle realizzate con una speciale lega antifrizione
- ✓ Forged pump head designed for strength
- ✓ Cam-Ground pistons for smoother stroke and better oil-tightness
- ✓ Oversized shaft and long end section for better torque transmission
- ✓ Extra-thick ceramic pistons for greater durability
- ✓ Double gasket sealing system
- ✓ Intake and delivery valves with larger water passages
- ✓ Ball bearings with high resistance
- ✓ Body of the pump designed for long-term durability
- ✓ Rods made of a special anti-friction alloy

ACCOPPIMENTO / PAIRING



MEC 100



MEC 112

USO / APPLICATION



PULIZIA
CLEANING



AGRICOLTURA
AGRICULTURE



SCARICA GLI SCHEMI TECNICI DAL NOSTRO SITO
TECHNICAL SHEETS AVAILABLE ON OUR SITE

www.e-mazzoni.it



POMPE AD ALTA PRESSIONE HIGH PRESSURE PUMPS



Codice Code	Modello Model	Portata Flow Rate				Pressione Pressure		Potenza Power				Albero Shaft L:40mm - Ø24
		1450 Rpm		1740 Rpm		Bar	Psi	50Hz		60Hz		
		L/min	Gpm	L/min	Gpm			HP	Kw	HP	Kw	
P3.010.022	PMD8200R	8,50	2,24	10,20	2,69	200,00	2900,76	4,42	3,30	5,30	3,95	Destra / Right
P3.010.023	PMD10200R	10,00	2,64	12,00	3,17	200,00	2900,76	5,19	3,87	6,23	4,65	Destra / Right
P3.010.024	PMD11200R	11,00	2,91	13,20	3,49	200,00	2900,76	5,71	4,26	6,86	5,12	Destra / Right
P3.010.025	PMD12200R	12,00	3,17	14,40	3,80	200,00	2900,76	6,23	4,65	7,48	5,58	Destra / Right
P3.010.026	PMD13200R	13,00	3,43	15,60	4,12	200,00	2900,76	6,75	5,03	8,10	6,04	Destra / Right
P3.010.027	PMD14200R	14,00	3,70	16,80	4,44	200,00	2900,76	7,27	5,42	8,73	6,51	Destra / Right
P3.010.021	PMD15200R	15,00	3,96	18,00	4,76	200,00	2900,76	7,79	5,81	9,35	6,97	Destra / Right
P3.010.029	PMD8200L	8,50	2,24	10,20	2,69	200,00	2900,76	4,42	3,30	5,30	3,95	Sinistra / Left
P3.010.030	PMD10200L	10,00	2,64	12,00	3,17	200,00	2900,76	5,19	3,87	6,23	4,65	Sinistra / Left
P3.010.031	PMD11200L	11,00	2,91	13,20	3,49	200,00	2900,76	5,71	4,26	6,86	5,12	Sinistra / Left
P3.010.032	PMD12200L	12,00	3,17	14,40	3,80	200,00	2900,76	6,23	4,65	7,48	5,58	Sinistra / Left
P3.010.033	PMD13200L	13,00	3,43	15,60	4,12	200,00	2900,76	6,75	5,03	8,10	6,04	Sinistra / Left
P3.010.034	PMD14200L	14,00	3,70	16,80	4,44	200,00	2900,76	7,27	5,42	8,73	6,51	Sinistra / Left
P3.010.028	PMD15200L	15,00	3,96	18,00	4,76	200,00	2900,76	7,79	5,81	9,35	6,97	Sinistra / Left

RICAMBI / SPARE PARTS

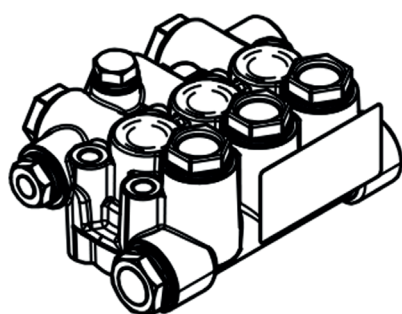

KIT - P9.040.002

TESTATA COMPLETA
COMPLETE HEAD OF THE PUMP



KIT - P9.039.001

ANELLI TENUTA OLIO ASTA
KIT OIL SEAL PUMP MMD PMD



KIT - P9.003.003

GUARNIZIONE PISTONE
KIT PLUNGER SEALS

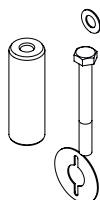

KIT - P9.004.023

PISTONE Ø18 POMPA PMD
KIT CERAMIC PISTON



KIT - P9.001.002

VALVOLA COMPLETA
COMPLETE VALVE



KIT - P9.003.004

GUARNIZIONE PISTONE Ø18 - PACCO COMPLETO
KIT COMPLETE SEALS

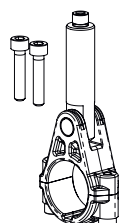

KIT - P9.041.008

PREMONTATO BIELLA - ASTA
PREASSEMBLED CONNECTING ROD